

REPKG 五通变径

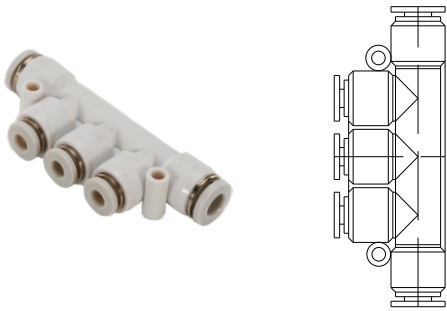

型号	$\phi D1 \times 2$	$\phi D2 \times 3$	A	E	$\phi P \times 5$
REPKG06-04	6	4	66	19	13
REPKG08-04	8	4	75	21	15
REPKG08-06	8	6	75	21.5	15
REPKG10-06	10	6	87	25	18.5
REPKG10-08	10	8	87	25	18.5
REPKG12-08	12	8	99.5	26.5	21
REPKG12-10	12	10	99.5	27.5	21

REPC-C 迷你型螺纹直通

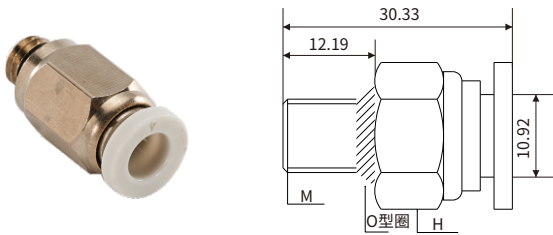

型号	ϕD	B	A	M	ϕP
TPC-C04-M3	4	17.5	3.5	M3	8
TPC-C04-M5		17.5	3.5	M5	8
TPC-C04-01		19.5	7	R1/8	10
TPC-C06-M3	6	20	3.5	M3	10
TPC-C06-M5		18	3.5	M5	10
TPC-C06-01		18.5	7	R1/8	10

REPOC-C 迷你型螺纹直通

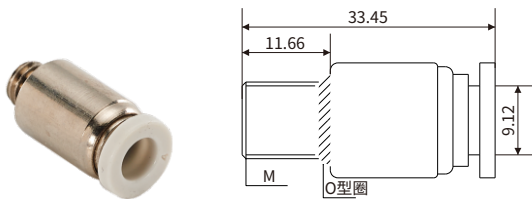

型号	ϕD	B	A	M	ϕP
REPOC-C04-M3	4	19.5	3.5	M3	8
REPOC-C04-M5		17.5	3.5	M5	8
REPOC-C04-01		19.5	7	R1/8	10
REPOC-C06-M3	6	20	3.5	M3	10
REPOC-C06-M5		18	3.5	M5	10
REPOC-C06-01		18.5	7	R1/8	10

REPL-C 迷你型螺纹弯通

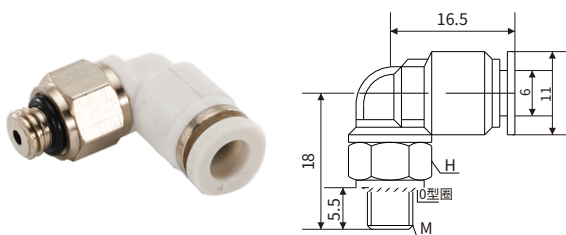

型号	ϕD	B	E	M	A	H	ϕP
REPL-C04-M3	4	15	14.5	M3	3.5	8	8.5
REPL-C04-M5		15	14.5	M5	3.5	8	8.5
REPL-C04-01		15	14.5	R1/8	7	10	8.5
REPL-C06-M3	6	15.5	16	M3	3.5	8	10.5
REPL-C06-M5		15.5	16	M5	3.5	8	10.5
REPL-C06-01		15.5	16	R1/8	7	10	10.5

REPU-C 迷你直通

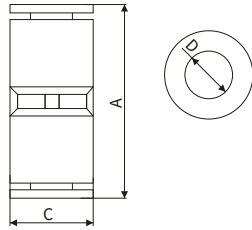

型号	A	D	C
REPU-C-4	27	4	9.5
REPU-C-6	29	6	11.5

REPV-C L型二通

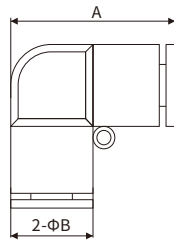

型号	A	B
REPV-C-4	19.5	9.5
REPV-C-6	22.5	11.5

REPE-C T型迷你三通

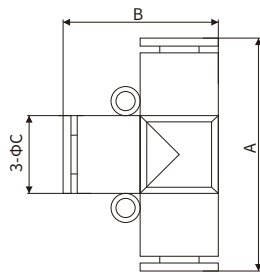

型号	A	D	C
REPE-C-4	30	20	9.5
REPE-C-6	34	23	11.5

REPY-C Y型迷你三通

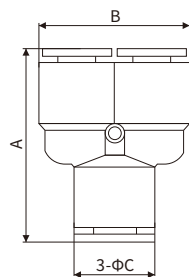

型号	A	D	C
REPY-C-4	29	19	9.5
REPY-C-6	32	23	11.5

REPZA-C 迷你四通

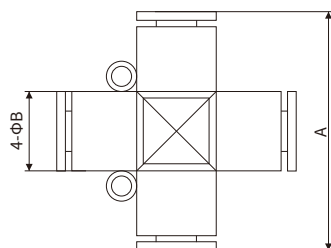

型号	A	B
REPZA-C-4	30	9.5
REPZA-C-6	34	11.5

REPK-C 迷你五通

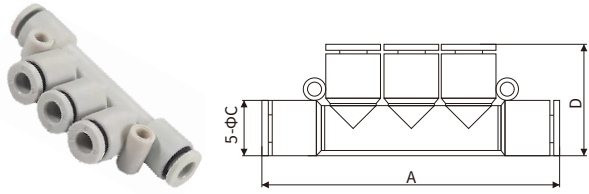

型号	A	D	C
REPK-C-4	48.5	20	9.5
REPK-C-6	57	23	11.5

REKLC-C 迷你快拧螺纹直通

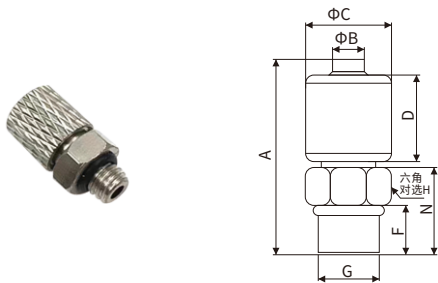

型号	A	B	C	D	G	F	N	H
4-M3	14.5	2.5	7	7	M3	3	6.5	7
4-M5	16	2.5	7	7	M5	3.5	7	7
6-M5	17.5	4	8.2	8.2	M5	3.5	7	8

REKLL-C 迷你快拧螺纹弯通

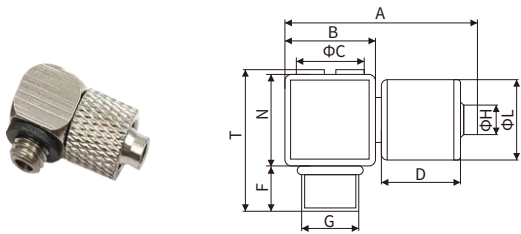

型号	A	B	C	D	G	F	N	H	T	L
4-M3	16.5	8	7	7	M3	3	8	2.5	11.5	7
4-M5	17	8	7	7	M5	3.5	8	2.5	12	7
6-M5	18	8	7	8.2	M5	3.5	8	4	12	8.2

REKLE-C 迷你快拧螺纹正三通

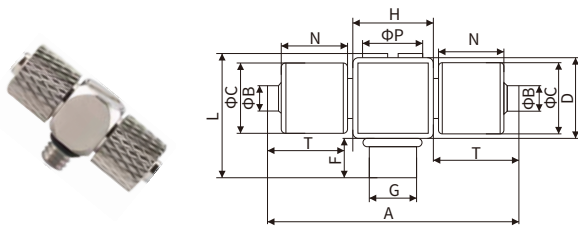

型号	A	B	C	D	G	F	N	H	P	L	T
4-M5	25	2.5	7	8	M5	3.5	7	8	7	12	8.5
6-M5	27	4	8.2	8	M5	3.5	8.2	8	7	12	9.5

REBG-C 迷你宝塔螺纹直通

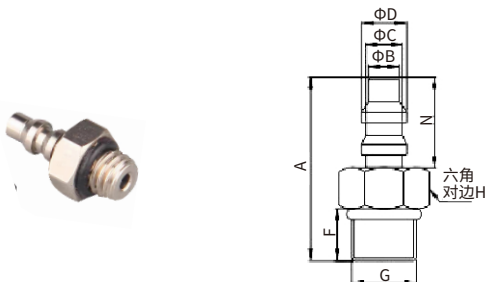

型号	A	B	C	D	G	F	N	H
4-M5	14.5	2.5	2.8	7	M5	3.5	7	7
6-M5	14.5	4	4.3	8.2	M5	3.5	7	7

REBGL-C 迷你宝塔螺纹弯通

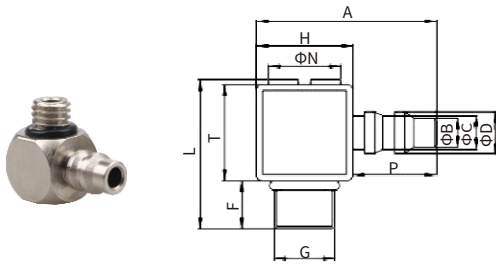

型号	A	B	C	D	G	F	N	H	P	L	T
4-M5	1.5	2.5	2.8	3.5	M5	3.5	7	8	7	12	8
6-M5	1.5	4	4.3	5	M5	3.5	7	8	7	12	8

REBGE-C 迷你宝塔螺纹正三通

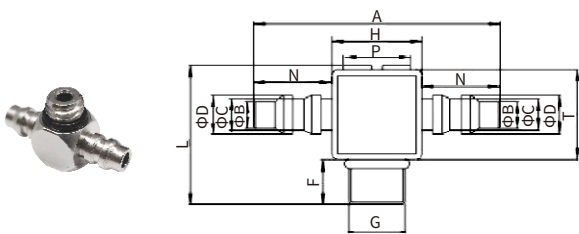

型号	A	B	C	D	G	F	N	H	P	L	T
4-M5	2.2	2.5	2.8	3.5	N5	3.5	7	8	7	12	8
6-M5	2.2	4	4.3	5	N5	3.5	7	8	7	12	8

REPC-G 螺纹直通

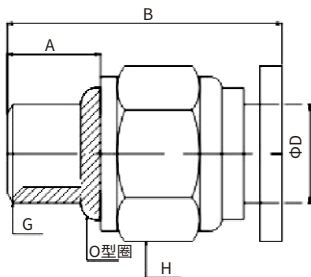

型号	ΦD	G	A	B	H
REPC4-M5	4	M5	3.5	18.5	10
REPC4-G01		G1/8	5.5	18.5	12
REPC4-G02		G1/4	6.5	18	15
REPC6-M5		M5	3.5	20	12
REPC6-G01	6	G1/8	5.5	20	12
REPC6-G02		G1/4	6.5	19	15
REPC6-G03		G3/8	7.5	19.5	19
REPC6-G04		G1/2	9.5	20.5	24
REPC8-G01	8	G1/8	5.5	22.5	14
REPC8-G02		G1/4	6.5	21.5	15
REPC8-G03		G3/8	7.5	19.5	19
REPC8-G04		G1/2	9.5	21.5	24
REPC10-G01	10	G1/8	5.5	24.5	17
REPC10-G02		G1/4	6.5	25.5	17
REPC10-G03		G3/8	7.5	24.5	19
REPC10-G04		G1/2	9.5	22.5	24
REPC12-G01	12	G1/8	5.5	26	19
REPC12-G02		G1/4	6.5	27	19
REPC12-G03		G3/8	7.5	25.5	19
REPC12-G04		G1/2	9.5	27.5	24
REPC14-G02	14	G1/4	6.5	28.5	21
REPC14-G03		G3/8	7.5	29.5	21
REPC14-G04		G1/2	9.5	28	24
REPC16-G02	16	G1/4	6.5	30.5	24
REPC16-G03		G3/8	7.5	31.5	24
REPC16-G04		G1/2	9.5	29.5	24